

## DOOR ADJUSTMENT prior to the installation of soni PORTA

1.

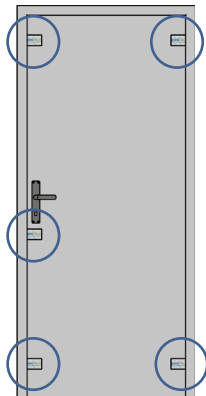

As a first step, please use a credit card or similar to check the correct setting of your door. To do this, try to insert the card between the door leaf and the door seal at five different points (see drawing). If the card can be inserted easily and without great resistance, please carry out the following steps to adjust the door. The door is correctly aligned when the card starts to stay put between the door leaf and the door seal at all five points. Only when this is the case, soni PORTA will achieve maximum acoustic effectiveness.

2.

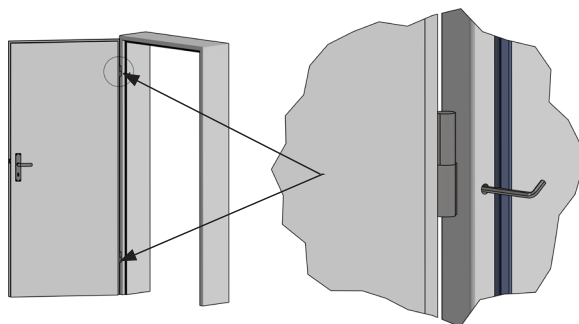

If the gap between the door seal and the door leaf is too wide, you can use a screwdriver or an Allen key to insert the frame-side hinge part deeper into the frame. To do this, first unhinge the door leaf. Adjust the hinge position until the credit card does start to stay put when inserted.

3.

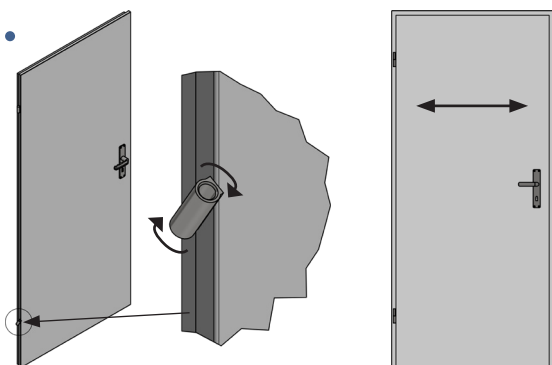

If the door leaf is positioned at a slight angle in the frame, it can be adjusted by turning the hinge(s) accordingly.

If you want the door leaf to tilt more towards the lock side, turn the upper hinge counterclockwise. Turning the hinge clockwise raises the door leaf on the lock side.

Practical tip: For easy turning, insert a screwdriver/ Allen key into the hinge.

4.

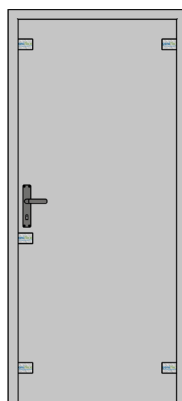

Please continue the adjustments according to steps 2 and 3 until the credit card stays put at all five test points. Only if this is the case, the door is installed correctly and with maximum acoustic insulation effect.